



VIVALDi
UNITED GROUP®

vivaldigroup.it

USE AND MAINTENANCE MANUAL

PH50M

Reflex Horn Speaker



Caution: Please carefully read this manual before operating.



Damage caused by misuse is not covered by warranty.

1. Read and keep these instructions.
2. Heed all warnings and follow all instructions.
3. Do not use this apparatus near water.
4. Do not block any ventilation openings. Install in accordance with the manufacturer's instructions.
5. Do not install near any heat sources such as radiators, heat registers, stoves, or other apparatus that produce heat.
6. Do not defeat the safety purpose of the polarized or grounding-type plug. A polarized plug has two blades with one wider than the other. A grounding type plug has two blades and a third grounding prong. The wide blade or the third prong is provided for your safety. If the provided plug does not fit into your outlet, consult an electrician for replacement of the obsolete outlet.
7. Protect the power cord from being walked on or pinched particularly at plugs, convenience receptacles, and the point where they exit from the apparatus.
8. Only use attachments/accessories specified by the manufacturer.
9. Use only with the cart, stand, tripod, bracket, or table specified by the manufacturer, or sold with the apparatus. When a cart is used, use caution when moving the cart/apparatus combination to avoid injury from tip-over.
10. Unplug this apparatus during lightning storms or when unused for long periods of time.
11. Refer all servicing to qualified service personnel. Servicing is required when the apparatus has been damaged in any way, such as power-supply cord or plug is damaged, liquid has been spilled or objects have fallen into the apparatus, the apparatus has been exposed to rain or moisture, does not operate normally, or has been dropped.
12. This appliance shall not be exposed to dripping or splashing water and that no object filled with liquid such as vases shall be placed on the apparatus.
13. Plug this apparatus to the proper wall outlet and make the plug to be disconnected readily operable.
14. Main plug is used as disconnected device and it should remain readily operable during intended use. In order to disconnect the apparatus from the mains completely, the mains plug should be disconnected from the mains socket outlet completely.
15. **WARNING:** To reduce the risk of fire or electric shock, do not expose this apparatus to rain or moisture.
16. An appliance with a protective earth terminal should be connected to a mains outlet with a protective earth connection.

WARNING!

TO PREVENT FIRE OR SHOCK HAZARD, DO NOT USE THE PLUG WITH
AN EXTENSION CORD, RECEPTACLE OR OTHER OUTLET UNLESS THE BLADES
CAN BE FULLY INSERTED TO PREVENT BLADE EXPOSURE.
TO REDUCE THE RISK OF FIRE OR ELECTRIC SHOCK, DO NOT EXPOSE
THIS APPLIANCE TO RAIN OR MOISTURE.
TO PREVENT ELECTRICAL SHOCK,
MATCH WIDE BLADE PLUG TO WIDE SLOT, FULLY INSERT.



The lightning flash with arrowhead symbol, within an equilateral triangle, is intended to alert the user to the presence of uninsulated "dangerous voltage" within the product's enclosure that may be of sufficient magnitude to constitute a risk of electric shock to persons.

CAUTION

RISK OF ELECTRIC SHOCK
DO NOT OPEN

WARNING: TO REDUCE THE RISK OF ELECTRIC SHOCK, DO NOT REMOVE COVER (OR BACK). NO USER SERVICEABLE PARTS INSIDE. REFER SERVICING TO QUALIFIED SERVICE PERSONNEL.



The exclamation point within an equilateral triangle is intended to alert the user to the presence of important operating and maintenance (servicing) instructions in the literature accompanying the appliance.

DESCRIPTION

Vivaldi PH50M Reflex Horn Speaker, rated at 50W, are designed for outdoor paging applications in houses of worship, factories, schools and so on. The speaker features newly developed diaphragms employing special heat-resistant polyimide film to prevent the diaphragm from absorbing moisture and changing shape, as well as to improve the low frequency characteristics. High speaker efficiency has also been realized by minimizing the gap produced when the diaphragm bobbin is installed in the magnetic circuitry slit. PH50M is designed to ensure high speech clarity and sound quality suitable for music reproduction. External hardware (screws, bolts, nuts) are made of stainless steel, and the mounting bracket and the horn itself are treated with 50-micron thick powder paint coating. All of these factors combine to ensure the speaker's excellent weatherproofing and corrosion resistance. In addition, the external horn flare is made of aluminum that is more shock-resistant than resin. PH50M is equipped with an input impedance selector switch (3 steps for 100V line, and 4 steps for 70V line) which facilitates the ease of impedance settings without requiring disassembly. The switch is also equipped with an OFF position to prevent speaker damage resulting from incorrect impedance setting.

FEATURES

- Compact and high power horn speaker.
- High durability, high heat-resistance and improved low frequency sound thanks to polyimide diaphragm.
- Stainless steel hardware (screws, bolts, nuts), and powder-coated horn and bracket for weatherproofing and corrosion-resistance.
- Shock-resistant aluminum round horn.
- Compliance with IP65.
- Easy impedance matching with panel-mounted input impedance selector.
- Wide temperature range: -20°C to 60°C (-4°F to 140°F).

APPEARANCE AND DIMENSIONAL DIAGRAM

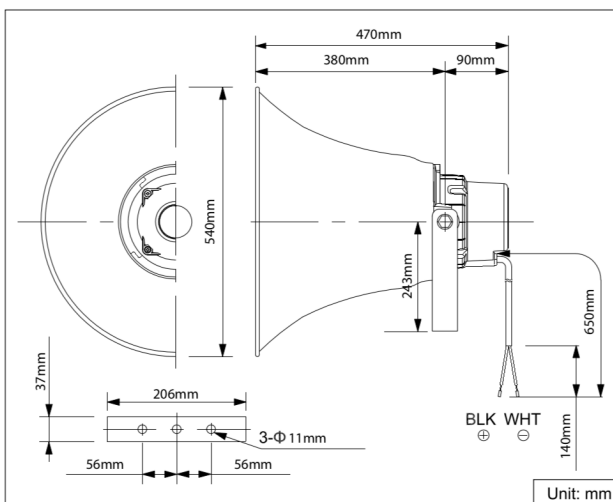

WIRING DIAGRAM

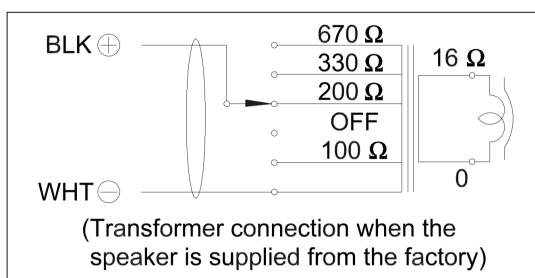

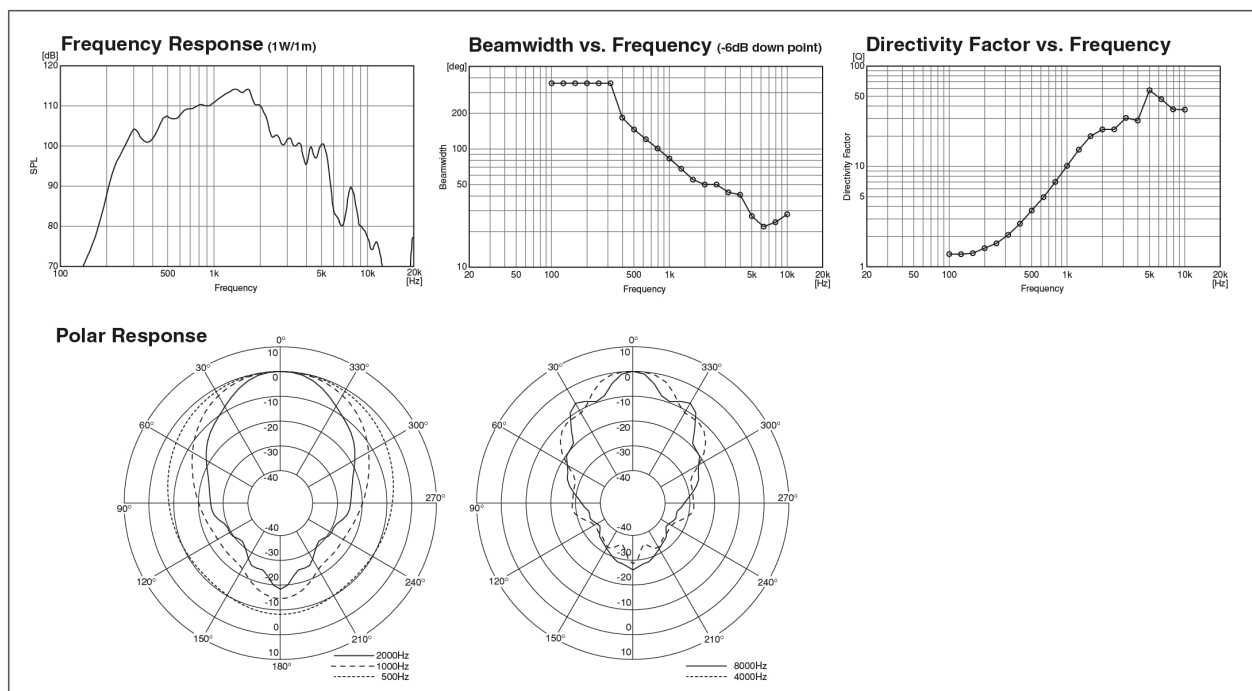

SPECIFICATIONS

Rated Input	50 W
Line Voltage	100 V line or 70 V line
Rated Impedance	100 V line: 200 Ω (50 W), 330 Ω (30 W), 670 Ω (15 W). 70 V line: 100 Ω (50 W), 200 Ω (25 W), 330 Ω (15 W), 670 Ω (7.5 W).
Sensitivity	111 dB (1 W, 1m)
Frequency Response	200 Hz – 6 kHz
Dust/Water Protection	IP65
Polarity	Hot: Black, Com: White
Operating Temperature	–20°C to +60°C (–4°F to 140°F) (must be free from dew condensation)
Finish	Horn flare: Aluminum, off-white, powder coating. Reflector horn: ABS resin, off-white. Bracket holder: Aluminum, white, powder coating. Bracket: Steel, gray, powder coating. Rear cover: ABS resin, gray. Screw and bolts: Stainless steel. Speaker Cable: Polyvinyl chloride insulated cabtyre cable (6 mm (0.24") in diameter, 600 mm (1.97 ft) in length).
Dimensions	Ø540 × 470 (D) mm
Weight	4 kg (8.82 lb)

SERVICE

Ensure the problem is not related to operator error, or system devices that are external to this unit. Information provided in the troubleshooting portion of this manual may help with this process. Once it is certain that the problem is related to the product contact your warranty provider as described in the warranty section of this manual.

WARRANTY

Warranty terms of global three years. While the term and warranty may vary by country and may not be the same for all products. Terms and conditions of warranty for a given product may be determined first by locating the appropriate country which the product was purchased in, then by locating the product type.



VIVALDI SRL by VIVALDI UNITED GROUP

Headquarter:

Via Enrico Fermi, 8
30020 Noventa di Piave (VE) - IT

Warehouse:

Via Edison, 4
30020 Noventa di Piave (VE) - IT

phone +39 0421.307825 - fax +39 0421.307845

e-mail info@vivaldigroup.it

web www.vivaldigroup.it

© 2019 Vivaldi Srl

Vivaldi srl ongoing effort to improve its products, reserves the right to make technical and aesthetic changes effectively without obligation to notice.